

6GF - 6GX 6GF HEAVY DUTY

6" SUBMERSIBLE MOTORS - 50 Hz

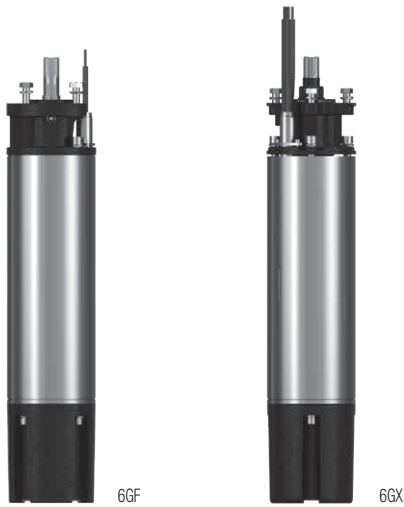



TECHNICAL DATA

Flanging: NEMA 6".

Insulation class: F.

Protection degree: IP 68.

Cooling flow speed: min. 0,3 m/s at 35°C

Three-phase power input: 3x230 V 50 Hz / 3x400 V 50 Hz

Power input tolerance: +6% / -10%.

Maximum number of starts per hour: 25/h.

Maximum operating depth: 300 m.

Horizontal operation: 5,5 HP - 50 HP.

Power cable: 4 m

On request: different cable lengths, different supply voltages, single-phase version (up to 15 HP).

6GF and 6GX are 6" submersible motors to be combined with a pump body, designed for pressurization systems, lifting water from underground and for use in irrigation systems in agriculture.

CONSTRUCTION FEATURES OF THE MOTOR

Built in AISI 304 with cathoresis-treated cast iron for the part immersed in water. Built-in resin-coated stator. Cooling and lubrication through a mixture of water and glycol. Combined with the hydraulics, it can draw water from pits of at least 6" (or tanks and cisterns). Single-phase versions to be combined with an external panel integrating the capacitor and thermo-amperometric protection with manual reset. Different versions available, with provision for installation of PT100 or PTC temperature sensor, also available with star-delta starting.



The stator is submerged in thermosetting insulating resin with high heat dissipation capacity, encapsulated in an airtight stainless steel casing, AISI 304 for the 6GF version and AISI 316 for the 6GX version.

Rotor mounted on a Kingsbury type self-centring thrust block capable of withstanding at high axial loads.

6GF - 6GX

SUBMERSIBLE MOTORS

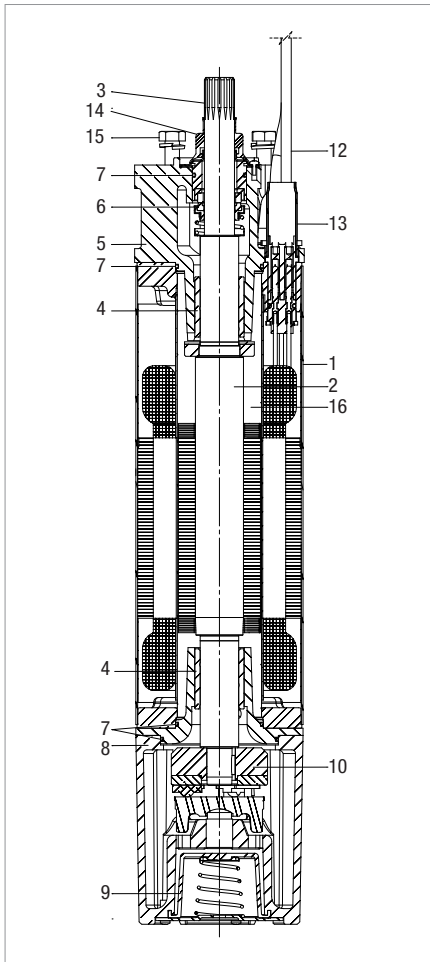

MATERIALS

N.	PARTS	VERSION 6GF	VERSION 6GX
1	INTERNAL AND EXTERNAL SLEEVE	STAINLESS STEEL EN 1.4307 - AISI 304L	STAINLESS STEEL EN 1.4571 - AISI 316Ti
2	SHAFT	STEEL ASTM A 105	STAINLESS STEEL EN 1.4401 - AISI 316
3	SHAFT END	STAINLESS STEEL EN 1.4401 - AISI 316	STAINLESS STEEL EN 1.4401 - AISI 316
4	BUSHINGS	GRAPHITE	GRAPHITE
5	UPPER BRACKET	CAST IRON EN 0.6020 + CATAPHORESIS COATING	STAINLESS STEEL EN 1.4401 - AISI 316
6	MECHANICAL SEAL	CARBON - CERAMIC	SIC/SIC
7	GASKET	NBR	VITON
8	LOWER BRACKET	CAST IRON EN 0.6020 + CATAPHORESIS COATING	STAINLESS STEEL EN 1.4401 - AISI 316
9	DIAPHRAGM	EPDM	EPDM
10	THRUST BEARING	STAINLESS STEEL + GRAPHITE	STAINLESS STEEL + GRAPHITE
11	VALVE	BRASS EN 12165	STAINLESS STEEL EN 1.4401 - AISI 316
12	CABLE	FLAT - 07XBH2-F	FLAT - 07XBH2-F
13	CONNECTING PLUG	STAINLESS STEEL EN 1.4301 - AISI 304	STAINLESS STEEL EN 1.4401 - AISI 316
14	SAND GUARD	NBR	EPDM
15	BOLTS & SCREWS	STEEL A2-70 - AISI 304	STEEL A4-70 - AISI 316
16	COOLING LIQUID	WATER + GLYCOL	WATER + GLYCOL

DIMENSIONS - SINGLE-PHASE MOTORS

TYPE	P2		LENGTH mm	WEIGHT 6GF kg	WEIGHT 6GX kg	AXIAL THRUST N
	hp	kW				
50 Hz	5	3,7	661	46,2	45	16000
	7,5	5,5	731	52,8	51	16000
	10	7,5	786	59,2	57,8	16000
	15	11	861	67,2	65,4	16000

DIMENSIONS - THREE-PHASE MOTORS

TYPE	P2		LENGTH mm	WEIGHT 6GF kg	WEIGHT 6GX kg	AXIAL THRUST N
	hp	kW				
50 Hz	5,5	4	601	41,2	39,7	16000
	7,5	5,5	631	44,3	42,8	16000
	10	7,5	661	47	45,5	16000
	12,5	9,2	686	50,1	48,6	16000
	15	11	731	54,5	53	16000
	17,5	13	761	58,4	56,9	16000
	20	15	786	61	59,5	16000
	25	18,5	861	68,5	67	16000
	30	22	921	74,3	72,8	16000
	35	26	980	78	77	16000
	40	30	1051	88,5	87	27000
	50	37	1181	101,6	100,1	27000
	60	45	1361	118,4	116,9	27000

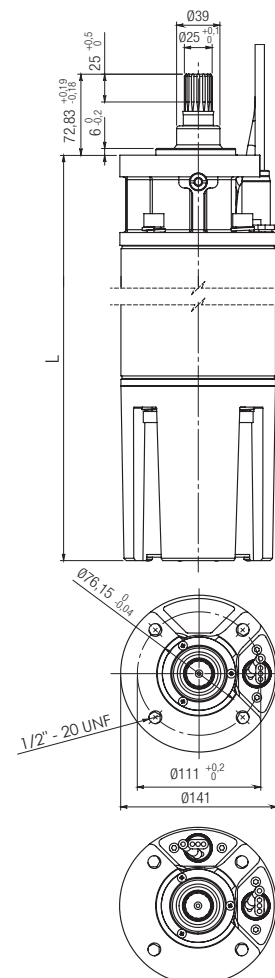

ELECTRICAL DATA - SINGLE-PHASE MOTORS

MODEL	P2		POWER INPUT 50Hz	I _n A	I _s / I _n	Ca / Cn	P1 W	N min ⁻¹	Cos φ	η %	C μF	CABLE	
	hp	kW										∅ mm ²	LC m
GGF / 6GX - 3,7 KW - 230 V - M	5	3,7	1 x 230 V ~	25	4,4	1,2	5100	2830	0,98	73	90	4X6	4
GGF / 6GX - 5,5 KW - 230 V - M	7,5	5,5	1 x 230 V ~	33,5	4	2	7450	2830	0,98	74	120	4X6	4
GGF / 6GX - 7,5 KW - 230 V - M	10	7,5	1 x 230 V ~	44	3,8	1,6	9900	2820	0,99	76	140	4X8	4
GGF / 6GX - 11 KW - 230 V - M	15	11	1 x 230 V ~	65	3,9	2	14200	2820	0,99	77	180	4X8	4

ELECTRICAL DATA - THREE-PHASE MOTORS - DIRECT STARTING

MODEL	P2 (HP)	P2 kW	POWER INPUT 50Hz	I _n (A)	I _s / I _n	P1 (W)	N (min ⁻¹)	Cos φ	η %	CABLE	
										∅ mm ²	LC m
GGF - 4 KW	5,5	4	3 x 400 V~	10,6	4,1	5290	2845	0,75	76	4x4	4
GGF - 5,5 KW	7,5	5,5	3 x 400 V~	14	4,6	7270	2845	0,75	76	4x4	4
GGF - 7,5 KW	10	7,5	3 x 400 V~	18	4,1	9550	2840	0,78	78	4x4	4
GGF - 9,2 KW	12,5	9,2	3 x 400 V~	22	3,9	11460	2840	0,8	80	4x4	4
GGF - 11 KW	15	11	3 x 400 V~	25,5	4,4	13860	2840	0,82	79	4x4	4
GGF - 13 KW	17,5	13	3 x 400 V~	29	4,6	16100	2840	0,8	81	4x4	4
GGF - 15 KW	20	15	3 x 400 V~	33,4	4,8	17960	2840	0,8	83	4x4	4
GGF - 18,5 KW	25	18,5	3 x 400 V~	41	5,2	22300	2845	0,8	83	4x4	4
GGF - 22 KW	30	22	3 x 400 V~	47	5,1	26500	2825	0,84	83	4x4	4
GGF - 26 KW	35	26	3 x 400 V~	57	4,9	31100	2830	0,83	84	4X8	4
GGF - 30 KW	40	30	3 x 400 V~	61,5	4,6	35130	2830	0,85	85	4X8	4
GGF - 37 KW	50	37	3 x 400 V~	79,3	3,7	44200	2830	0,84	82	4X8	4
GGF - 45 KW	60	45	3 x 400 V~	95	5,5	55000	2840	0,83	82	4X8	4

3 X 230 V voltages up to 22 kW available on request
 SUPPLIED WITH 1 CABLE

ELECTRICAL DATA - THREE-PHASE MOTORS - STAR/DELTA STARTING

MODEL	P2 (HP)	P2 kW	POWER INPUT 50Hz	I _n (A)	I _s / I _n	P1 (W)	N (min ⁻¹)	Cos φ	η %	CABLE	
										∅ mm ²	LC m
GGF - 4 KW	5,5	4	3 x 400 V~	10,6	4,1	5290	2845	0,75	76	4X4	4
GGF - 5,5 KW	7,5	5,5	3 x 400 V~	14	4,6	7270	2845	0,75	76	4X4	4
GGF - 7,5 KW	10	7,5	3 x 400 V~	18	4,1	9550	2840	0,78	78	4X4	4
GGF - 9,2 KW	12,5	9,2	3 x 400 V~	22	3,9	11460	2840	0,8	80	4X4	4
GGF - 11 KW	15	11	3 x 400 V~	25,5	4,4	13860	2840	0,82	79	4X4	4
GGF - 13 KW	17,5	13	3 x 400 V~	29	4,6	16100	2840	0,8	81	4X4	4
GGF - 15 KW	20	15	3 x 400 V~	33,4	4,8	17960	2840	0,8	83	4X4	4
GGF - 18,5 KW	25	18,5	3 x 400 V~	41	5,2	22300	2845	0,8	83	4X4	4
GGF - 22 KW	30	22	3 x 400 V~	47	5,1	26500	2825	0,84	83	4X4	4
GGF - 30 KW	40	30	3 x 400 V~	61,5	4,6	35130	2830	0,85	85	4x8	4
GGF - 37 KW	50	37	3 x 400 V~	79,3	3,7	44200	2830	0,84	82	4x8	4
GGF - 45 KW	60	45	3 x 400 V~	95	5,5	55000	2840	0,83	82	4x8	4

Supplied with 1 cable.
 3 X 230 V voltages up to 22 kW available on request

6GF HEAVY DUTY

6" SUBMERSIBLE MOTORS



TECHNICAL DATA

Maximum operating depth: 300 m

Flanging: NEMA 6"

Maximum number of starts per hour: 25/h

Protection degree: IP68

Insulation class: F

Cooling flow speed: min. 0,3 m/s 35°C

Max thrust load: 50 kN

Three phase power input: 3x400V 50 Hz

Power input tolerance: +6% / -10%

Power cable: 4 m

Possible type of installation: vertical

Special versions on request: it is available with additional PT100 or PTC temperature sensor. Voltage and power cables of different length.

Certificates: ACS, WRAS and KTW certified cable.

Encapsulated 6" submersible motor made in AISI 304 and cathoporesis treated cast iron. Resin filled stator. Cooling and lubrication are guaranteed by a mixture of water and glycol. 6GF heavy duty motors are design for very deep borehole installation.

CONSTRUCTION FEATURES OF THE MOTOR

Two pole asynchronous motor in AISI 304 stainless steel and cathoporesis treated cast iron for parts in contact with water. Cooling and lubrication of the thrust unit and bushings guaranteed by a mixture of water and glycol. Mitchell type self-centering thrust unit with 50kN axial load. The stator is filled with resin with high heat dissipation capacity. Removable cable connector. ACS, WRAS and KTW certified cable. Motor suitable for use with variable frequency drive (30 Hz - 50 Hz). The protection must be guaranteed by the user. Available with direct or star-delta start. It is available with additional PT100 or PTC temperature sensor.



MECHANICAL SEAL

Sic Sic as STD,
reinforced top support



**HEAVY DUTY
THRUST BEARING,**
max axial load 50 kN



IMPROVED DIAPHRAGM

Stronger material and design
for an higher reliability



6GF HEAVY DUTY

6" SUBMERSIBLE MOTORS

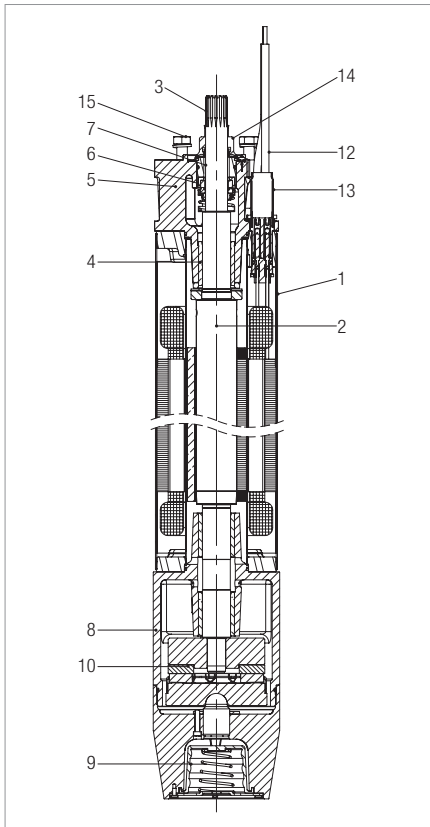

MATERIALS

N.	PARTS	MATERIALS
1	EXTERNAL SLEEVE	STAINLESS STEEL EN 1.4307 - AISI 304L
2	SHAFT	STEEL ASTM A 105
3	SHAFT END	STAINLESS STEEL EN 1.4404 - AISI 316L
4	BUSHINGS	GRAPHITE
5	UPPER BRACKET	CAST IRON EN 0.6020 + CATAPHORESIS COATING
6	MECHANICAL SEAL	SIC - SIC
7	GASKET	NBR
8	LOWER BRACKETS	CAST IRON EN 0.6025 + CATAPHORESIS COATING
9	DIAPHRAGM	FKM
10	THRUST BEARING	CERAMIC - GRAPHITE
11	VALVE	BRASS CW614N
12	CABLE EU	FLAT - 07XBH2-F
	CABLE US	RHW-2 OR RHW OR RHH 600V
13	CONNECTING PLUG	STAINLESS STEEL EN 1.4301 - AISI 304
14	SAND GUARD	NBR 70
15	BOLTS & SCREWS	STEEL A2-70 - AISI 304
16	COOLING LIQUID	WATER + GLYCOL

DIMENSIONS

MODEL	LENGTH mm	MOTOR DIAMETER mm	AXIAL THRUST N	WEIGHT kg	PACKING DIMENSIONS mm		
					L	B	H
6GF - 22 KW - HD	1017	144	50000	97	1398	188	339
6GF - 30 KW - HD	1147	144	50000	107	1398	188	339
6GF - 37 KW - HD	1277	144	50000	120	1398	188	339
6GF - 45 KW - HD	1457	144	50000	139	1628	188	339

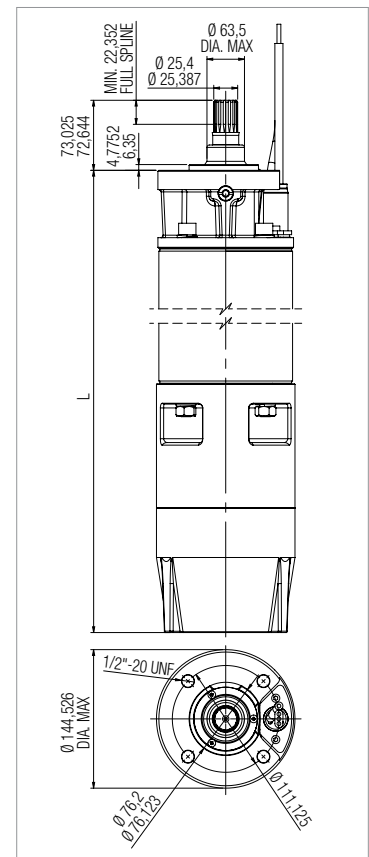

ELECTRICAL DATA - DIRECT STARTING

MODEL	P2 (HP)	P2 kW	POWER INPUT 50 Hz	IN (A)	Is/In	P1 (W)	N (min ⁻¹)	cos φ	η %	CABLE	
										∅ mm ²	LC (m)
6GF - 22 KW HEAVY DUTY	30	22	3 x 400 V ~	47	5,1	26500	2825	0,84	83	4x6	4
6GF - 30 KW HEAVY DUTY	40	30	3 x 400 V ~	61,5	4,6	35500	2830	0,85	85	4x8	4
6GF - 37 KW HEAVY DUTY	50	37	3 x 400 V ~	79,3	3,7	45000	2830	0,84	82	4x8	4
6GF - 45 KW HEAVY DUTY	60	45	3 x 400 V ~	95	5,5	55000	2840	0,83	82	4x8	4

Star-delta starting on request.



MAKING WATER EASY

Via Marco Polo, 14 - 35035 Mestrino (PD) Italy - Tel. +39.049.5125000 - Fax +39.049.5125950

www.dabpumps.com



On-line product selection



DAB PUMPS LTD.
Unit 6 Gilberd Court
Newcomen Way, Severalls Park
CO4 9WN
Colchester
ordersuk@dwtgroup.com
Tel. +44 0333 777 5010



DAB PUMPS IBERICA S.L.
Calle Verano 18-20-22
28850 - Torrejón de Ardoz - Madrid
Spain
Info.spain@dwtgroup.com
Tel. +34 91 6569545



DAB PUMPS DE MÉXICO, S.A. DE C.V.
Av Amsterdam 101 Local 4
Col. Hipódromo Condesa,
Del. Cuauhtémoc CP 06170
Ciudad de México
Tel. +52 55 553 2621



DAB PUMPS BV
'tHofveld 6 C1
1702 Groot Bijgaarden - Belgium
info.belgium@dwtgroup.com
Tel. +32 2 4668353



DAB PUMPS HUNGARY KFT.
H-8800
Nagykanizsa, Buda Ernő u.5
Hungary
Tel. +36 93501700



DAB PUMPS SOUTH AFRICA (PTY) LTD
Twenty One industrial Estate,
16 Purlin Street, Unit B, Warehouse 4
Olifantsfontein -1667 - South Africa
info.sa@dwtgroup.com
Tel. +27 12 361 3997



DAB PUMPS B.V.
Statenlaan, 4
5223 LA, 's-Hertogenbosch
Nederland
info.nl@dabpumps.com
Tel. +31 416 387280



DAB PUMPS POLAND Sp. z o.o.
Ul. Cieslewskich 35K
03-017 Warszawa - Poland
sprzedaz@dabpumps.com.pl



DAB PUMPS (QINGDAO) CO. LTD.
No.10 Xindong Road
Jiulong Town,
Jiaozhou City
266319 Qingdao (Shandong) - China
sales.cn@dwtgroup.com
Tel. +86 400 186 8280



DAB PUMPS FRANCE SAS
Tour Ariane, Paris la Défense 9
5, Place de la Pyramide
92800 Puteaux - France
info.fr@dabpumps.com
Tel. +33 (0)6 79 63 05 46
+33 (0)7 89 01 53 35



DAB PUMPS INC.
3226 Benchmark Drive
Ladson, SC 29456 - USA
info.usa@dwtgroup.com
Tel. 1- 843-797-5002
Fax 1-843-797-3366



DAB PUMPS OCEANIA PTY LTD
426 South Gippsland Highway,
Dandenong South VIC 3175 - Australia
info.oceania@dwtgroup.com
Tel. +61 1300 378 677



DAB PUMPS GMBH
Am Nordpark 3
D - 41069 Mönchengladbach - Germany
info.germany@dwtgroup.com
Tel. +49 2161 47388-0
Fax +49 2161 47388-36



DAB PUMPS CANADA INC.
333 Bay Street, Suite 4600, Toronto,
Ontario, M5H 2S5, - Canada
orders@dwtgroup.ca
Tel. 1-833-322-7867



PT DAB PUMPS INDONESIA
Satrio Tower lantai 26
unit C-D, Jl. Prof. Dr. Satrio Kav. C4,
Kel. Kuningan Timur, Kec. Setiabudi, Kota Adm.
Jakarta Selatan, Prov. DKI Jakarta. - Indonesia
Tel. +62 2129222850