

PULSAR PULSAR DRY

SUBMERSIBLE PUMPS





TECHNICAL DATA

Operating range: 0.9 to 7.2 m³/h with head up to 88 metres.

Maximum immersion depth: 20 m

Type of pumped liquid: clean, free from solid or abrasive substances, non-viscous, non-aggressive, non-crystallized and chemically neutral

Sand quantity: 50 g/m³

Liquid temperature range: from 0°C to +40°C

Flanges, thread: 1" 1/4 GAS

Pump maximum diameter: 138 mm

Impeller/s material: technopolymer

Maximum number of starts: 20/h

Protection class: IP68

Motor insulation class: F

Single phase power input: 230 V 50 Hz

Three phase power input: 3x230 V 50 Hz / 3x400 V 50 Hz

Power cable (m) and plug: 15 m H07RN-F

Possible type of installation: fixed or portable, vertical and horizontal

Special versions on request: different voltages and frequencies, different cable lengths, different plugs

5" submersible multi-impeller single bloc pump with pump body in stainless steel. The single-phase versions can be supplied with float for automatic operation. Pump for pressurization, lifting water and gardening and irrigation in residential building service.

CONSTRUCTION FEATURES OF THE PUMP

Pump body in AISI 304 stainless steel. Technopolymer impellers, diffusers, filter and oil chamber. Hydraulic part positioned under the motor. Double mechanical seal with interposed oil chamber, ceramic-carbon on the motor side and silicon carbide on the pump side. The applied sealing system guarantees the watertight seal of the motor and the good functioning of the mechanical seal even in case of short dry running.

CONSTRUCTION FEATURES OF THE MOTOR

Continuous duty asynchronous submersible motor, cooled by the pumped liquid. Rotor mounted on oversized ball bearings. Motor shaft in AISI 303 stainless steel. Stator inserted in an airtight stainless steel casing and covered by a lid that contains wiring and condenser. Thermo-amperometric protection and permanent capacitor included in the standard single-phase version. Protection by the user in the three-phase version.

PULSAR CB, PULSAR DRY CB/ CONTROL BOX

Electrical control panel for operating Pulsar CB single-phase submersible electric pumps, containing manual reset thermal protection, capacitor and terminal board for electrical connections and possible pressure switch/float connection.

– Denomination index:
(example)

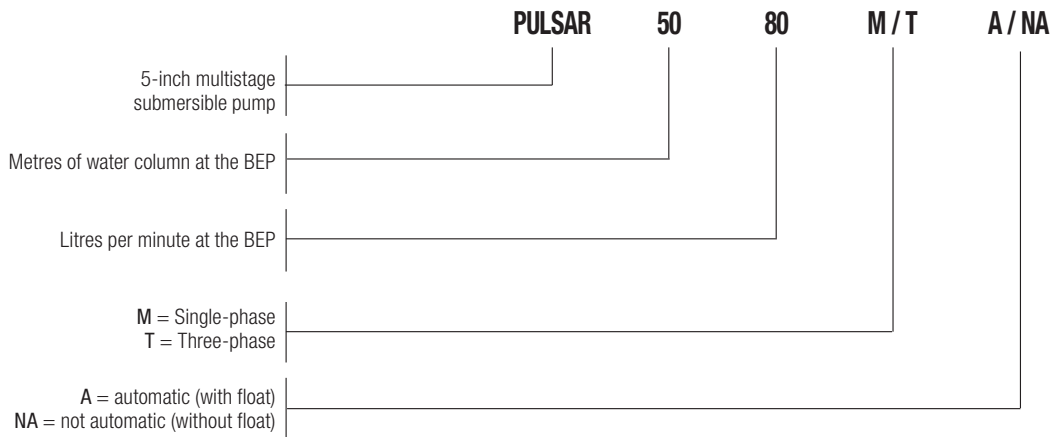

MATERIALS

N.	PARTS	MATERIALS
1	IMPELLER	TECHNOPOLYMER
2	DIFFUSER	TECHNOPOLYMER
3	SHAFT WITH ROTOR	AISI 303 (Part in contact with the pumped liquid)
4	STATOR SLEEVE	AISI 304
5	UPPER MECHANICAL SEAL	NBR / ALUMINA / CARBON
6	LOWER MECHANICAL SEAL	NBR / SIC / CARBON
7	SUCTION STRAINER	TECHNOPOLYMER
8	EXTERNAL SLEEVE	AISI 304
9	UPPER BEARING SUPPORT	BRONZE ALLOY
10	LOWER BEARING SUPPORT	BRONZE ALLOY
11	STRAINER COVER	AISI 304
12	DIFFUSER HOUSING	TECHNOPOLYMER
13	OIL CHAMBER	TECHNOPOLYMER
14	LUBRICANT OIL	ESSO MARCOL 172 OIL
15	COVER ELECTRICAL BOX	TECHNOPOLYMER
16	REAR DISC	TECHNOPOLYMER
17	CAPACITOR	-

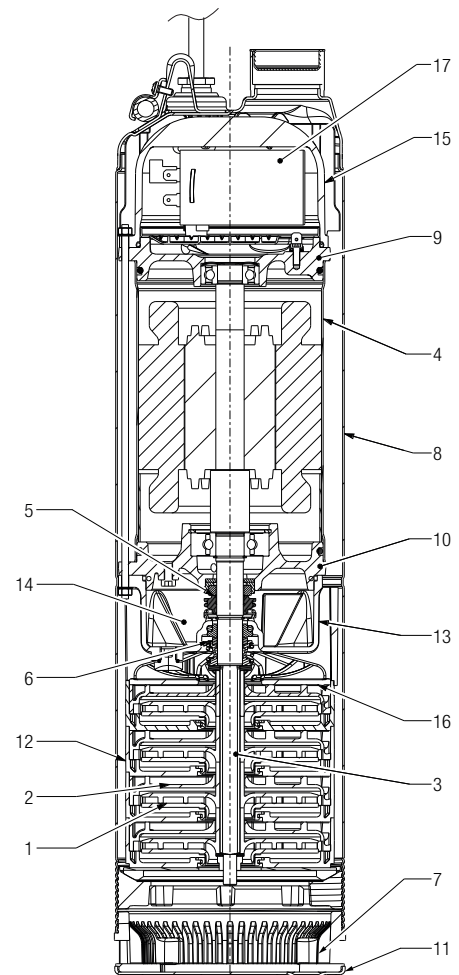

PERFORMANCE AT 50 Hz

MODEL	HYDRAULIC DATA							
	Q=m³/h	0	1,2	2,4	3,6	4,8	6	7,2
	Q=l/min	0	20	40	60	80	100	120
PULSAR 30/50	H (mt)	44	42	37	29	18	-	-
PULSAR 40/50		57	53	48	36	22	-	-
PULSAR 50/50		72	68	60	46,5	31	-	-
PULSAR 65/50		88	83	74	60	38,5	-	-
PULSAR 30/80		49	46	43	37	31	22,5	12
PULSAR 40/80		64	60	56	48	41	31	18
PULSAR 50/80		75	71	66	60	50	37	20

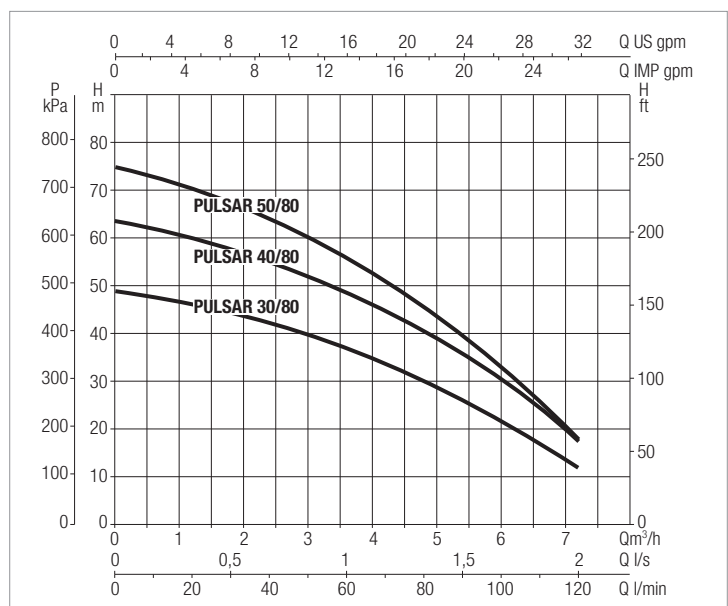
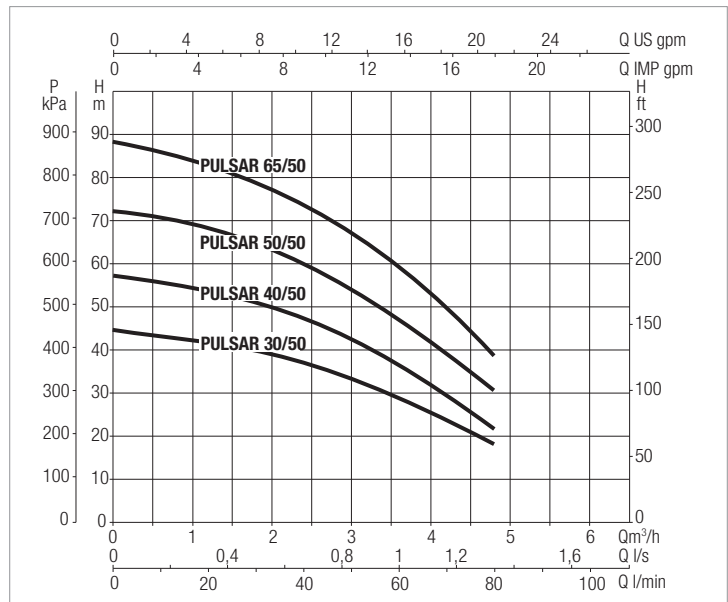
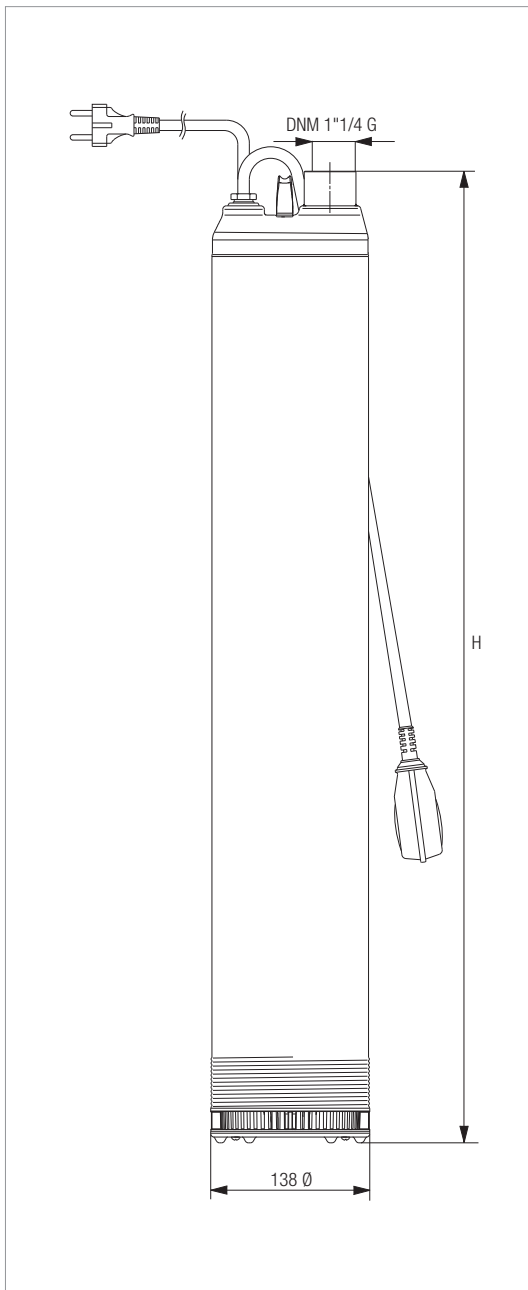

The performance curves are based on kinematic viscosity values = 1 mm²/s and density equivalent to 1000 kg/m³. Curve tolerance according to ISO 9906

ELECTRICAL DATA AND DIMENSIONS - PULSAR 50

MODEL	ELECTRICAL DATA							H mm	PACKING DIMENSIONS			VOLUME PACKING m ³	Q.TY X PALLET	WEIGHT kg
	POWER INPUT 50 Hz	P1 kW	P2 NOMINAL		In A	CAPACITOR			L/A	L/B	H			
			kW	HP		µF	Vc							
PULSAR 30/50 M-A	1 x 230 V ~	1	0,65	0,87	4,5	20	450	562	720	180	240	0,031	18	17,3
PULSAR 30/50 M-NA	1 x 230 V ~	1	0,65	0,87	4,5	20	450	562	720	180	240	0,031	18	16,7
PULSAR 30/50 T-NA	3 x 230 V ~	1	0,64	0,86	3,4	-	-	562	720	180	240	0,031	18	17,3
	3 x 400 V ~	1	0,64	0,86	2	-	-	562	720	180	240	0,031	18	17,3
PULSAR 40/50 M-A	1 x 230 V ~	1,2	0,77	1	5,4	20	450	562	720	180	240	0,031	18	17,5
PULSAR 40/50 M-NA	1 x 230 V ~	1,2	0,77	1	5,4	20	450	562	720	180	240	0,031	18	17
PULSAR 40/50 T-NA	3 x 230 V ~	1,2	0,79	1,1	3,9	-	-	562	720	180	240	0,031	18	17,5
	3 x 400 V ~	1,2	0,79	1,1	2,2	-	-	562	720	180	240	0,031	18	17,5
PULSAR 50/50 M-A	1 x 230 V ~	1,6	1,13	1,5	7,35	25	450	630	720	180	240	0,031	18	18,5
PULSAR 50/50 M-NA	1 x 230 V ~	1,6	1,13	1,5	7,35	25	450	630	720	180	240	0,031	18	18
PULSAR 50/50 T-NA	3 x 230 V ~	1,5	1,12	1,5	4,85	-	-	630	720	180	240	0,031	18	18,5
	3 x 400 V ~	1,5	1,12	1,5	2,8	-	-	630	720	180	240	0,031	18	18,5
PULSAR 65/50 M-A	1 x 230 V ~	1,9	1,3	1,7	8,3	30	450	657	720	180	240	0,031	18	19,5
PULSAR 65/50 M-NA	1 x 230 V ~	1,9	1,3	1,7	8,3	30	450	657	720	180	240	0,031	18	19
PULSAR 65/50 T-NA	3 x 230 V ~	1,8	1,3	1,7	6,1	-	-	657	720	180	240	0,031	18	19,5
	3 x 400 V ~	1,8	1,3	1,7	3,5	-	-	657	720	180	240	0,031	18	19,5

ELECTRICAL DATA AND DIMENSIONS - PULSAR CB 50

MODEL	ELECTRICAL DATA							H mm	PACKING DIMENSIONS			VOLUME PACKING m ³	Q.TY X PALLET	WEIGHT kg
	POWER INPUT 50 Hz	P1 kW	P2 NOMINAL		In A	CAPACITOR			L/A	L/B	H			
			kW	HP		µF	Vc							
PULSAR CB 30/50 M-A	1 x 230 V ~	1	0,65	0,87	4,5	-	-	562	720	180	240	0,031	18	17,3
PULSAR CB 30/50 M-NA	1 x 230 V ~	1	0,65	0,87	4,5	-	-	562	720	180	240	0,031	18	16,7
PULSAR CB 40/50 M-A	1 x 230 V ~	1,2	0,77	1	5,4	-	-	562	720	180	240	0,031	18	17,5
PULSAR CB 40/50 M-NA	1 x 230 V ~	1,2	0,77	1	5,4	-	-	562	720	180	240	0,031	18	17
PULSAR CB 50/50 M-A	1 x 230 V ~	1,6	1,13	1,5	7,35	-	-	630	720	180	240	0,031	18	18,5
PULSAR CB 50/50 M-NA	1 x 230 V ~	1,6	1,13	1,5	7,35	-	-	630	720	180	240	0,031	18	18
PULSAR CB 65/50 M-A	1 x 230 V ~	1,9	1,3	1,7	8,3	-	-	657	720	180	240	0,031	18	19,5
PULSAR CB 65/50 M-NA	1 x 230 V ~	1,9	1,3	1,7	8,3	-	-	657	720	180	240	0,031	18	19

ELECTRICAL DATA AND DIMENSIONS - PULSAR 80

MODEL	ELECTRICAL DATA							H mm	PACKING DIMENSIONS			VOLUME PACKING m ³	Q.TY X PALLET	WEIGHT kg
	POWER INPUT 50 Hz	P1 kW	P2 NOMINAL		In A	CAPACITOR			L/A	L/B	H			
			kW	HP		μF	Vc							
PULSAR 30/80 M-A	1 x 230 V ~	1,2	0,78	1,1	5,5	20	450	562	720	180	240	0,031	18	17,5
PULSAR 30/80 M-NA	1 x 230 V ~	1,2	0,78	1,1	5,5	20	450	562	720	180	240	0,031	18	17
PULSAR 30/80 T-NA	3 x 230 V ~	1,2	0,78	1,1	4	-	-	562	720	180	240	0,031	18	17,5
	3 x 400 V ~	1,2	0,78	1,1	2,3	-	-	562	720	180	240	0,031	18	17,5
PULSAR 40/80 M-A	1 x 230 V ~	1,6	1,1	1,5	7,4	25	450	630	720	180	240	0,031	18	18,5
PULSAR 40/80 M-NA	1 x 230 V ~	1,6	1,1	1,5	7,4	25	450	630	720	180	240	0,031	18	18
PULSAR 40/80 T-NA	3 x 230 V ~	1,5	1,1	1,5	4,85	-	-	630	720	180	240	0,031	18	18,5
	3 x 400 V ~	1,5	1,1	1,5	2,8	-	-	630	720	180	240	0,031	18	18,5
PULSAR 50/80 M-A	1 x 230 V ~	1,9	1,3	1,7	8,3	30	450	657	720	180	240	0,031	18	19,5
PULSAR 50/80 M-NA	1 x 230 V ~	1,9	1,3	1,7	8,3	30	450	657	720	180	240	0,031	18	19
PULSAR 50/80 T-NA	3 x 230 V ~	1,8	1,3	1,7	5,9	-	-	657	720	180	240	0,031	18	19,5
	3 x 400 V ~	1,8	1,3	1,7	3,4	-	-	657	720	180	240	0,031	18	19,5

ELECTRICAL DATA AND DIMENSIONS - PULSAR CB 80

MODEL	ELECTRICAL DATA							H mm	PACKING DIMENSIONS			VOLUME PACKING m ³	Q.TY X PALLET	WEIGHT kg
	POWER INPUT 50 Hz	P1 kW	P2 NOMINAL		In A	CAPACITOR			L/A	L/B	H			
			kW	HP		μF	Vc							
PULSAR CB 30/80 M-A	1 x 230 V ~	1,2	0,78	1,1	5,5	-	-	562	720	180	240	0,031	18	17,5
PULSAR CB 30/80 M-NA	1 x 230 V ~	1,2	0,78	1,1	5,5	-	-	562	720	180	240	0,031	18	17
PULSAR CB 40/80 M-A	1 x 230 V ~	1,6	1,1	1,5	7,4	-	-	630	720	180	240	0,031	18	18,5
PULSAR CB 40/80 M-NA	1 x 230 V ~	1,6	1,1	1,5	7,4	-	-	630	720	180	240	0,031	18	18
PULSAR CB 50/80 M-A	1 x 230 V ~	1,9	1,3	1,7	8,3	-	-	657	720	180	240	0,031	18	19,5
PULSAR CB 50/80 M-NA	1 x 230 V ~	1,9	1,3	1,7	8,3	-	-	657	720	180	240	0,031	18	19

PULSAR DRY

SUBMERSIBLE PUMPS



TECHNICAL DATA

Flow rate maximum: from 0,9 m³/h to 7,2 m³/h

Head up to: 88 m

Maximum immersion depth: 20 m

Type of pumped liquid: clean, free from solid or abrasive substances, non-viscous, non-aggressive, non-crystallized and chemically neutral

Sand quantity: 50 g/m³

Liquid temperature range: from 0°C to +40°C

Flanges, thread: 1" 1/4 GAS

Pump maximum diameter: 138 mm

Impeller/s material: technopolymer

Maximum number of starts: 20/h

Protection class: IP 68

Motor insulation class: F

Single phase power input: 230 V 50 Hz

Three phase power input: 3x230 V 50 Hz / 3x400 V 50 Hz

Power cable (m) and plug: 15 m H07RN-F

Possible type of installation: fixed or portable in a vertical position.

Special versions on request: different voltages and frequencies, different cable length

5" Submersible or surface pump, monobloc multi-impeller with pump body in stainless steel, for pressurization, gardening and irrigation in residential building service.

CONSTRUCTION FEATURES OF THE PUMP

Pump body in AISI 304 stainless steel. Technopolymer impellers, diffusers, filter and oil chamber. Hydraulic part positioned under the motor. Double mechanical seal with interposed oil chamber, ceramic-carbon on the motor side and silicon carbide on the pump side. The applied sealing system guarantees the watertight seal of the motor and the good functioning of the mechanical seal even in case of short dry running. Side suction through threaded fitting (1" 1/4 GAS) and vertical delivery

CONSTRUCTION FEATURES OF THE MOTOR

Continuous duty asynchronous submersible motor, cooled by the pumped liquid. Rotor mounted on oversized ball bearings. Motor shaft in AISI 303 stainless steel. Stator inserted in an airtight stainless steel casing and covered by a lid that contains wiring and capacitor. Thermo-amperometric protection and permanent capacitor included in the standard single-phase version. Protection by the user in the three-phase version and CB version.

PULSAR DRY

SUBMERSIBLE PUMPS

– Denomination index:
(example)

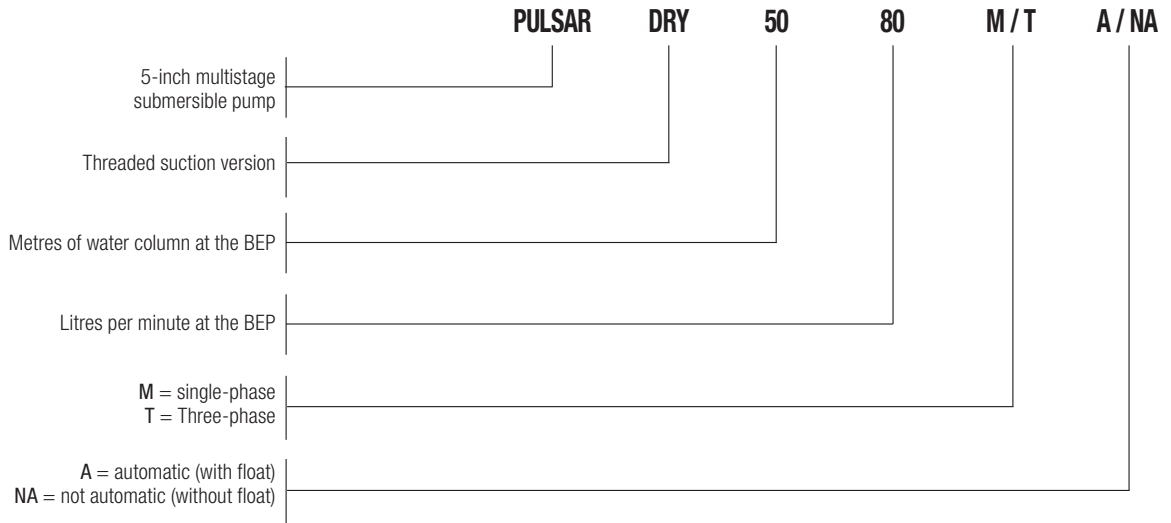

MATERIALS

N.	PARTS*	MATERIALS
1	IMPELLER	TECHNOPOLYMER
2	DIFFUSER	TECHNOPOLYMER
3	ROTOR SHAFT	AISI 303
4	MOTOR CASING WITH WOUND STATOR	AISI 304
5	UPPER MECHANICAL SEAL	NBR / ALUMINA / CARBON
6	COMPLETE LOWER MECHANICAL SEAL	NBR / SIC / CARBON
7	PUMP BASE	AISI 304
8	PUMP BODY	AISI 305
9	UPPER BEARING SUPPORT	COPPER ALLOY
10	LOWER BEARING SUPPORT	COPPER ALLOY
11	CAPACITOR	-
12	DIFFUSER HOUSING	TECHNOPOLYMER
13	OIL CHAMBER	TECHNOPOLYMER
14	LUBRICANT OIL	ESSO MARCOL 172 OIL
15	COVER ELECTRICAL BOX	TECHNOPOLYMER
16	REAR DISC	TECHNOPOLYMER

* In contact with the pumped liquid.

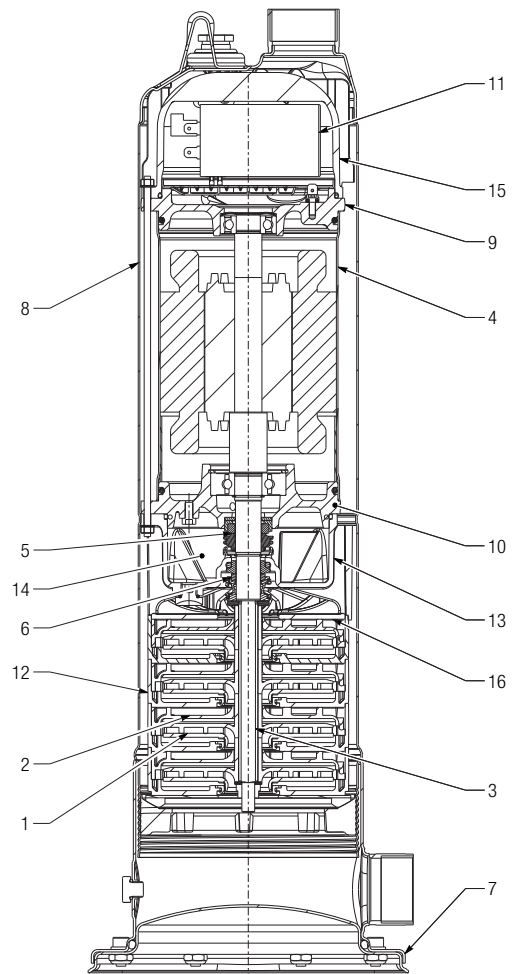

PULSAR DRY

SUBMERSIBLE PUMPS

PERFORMANCE AT 50 Hz

MODEL	HYDRAULIC DATA							
	Q=m ³ /h	0	1,2	2,4	3,6	4,8	6	7,2
	Q=l/min	0	20	40	60	80	100	120
PULSAR DRY 30/50		44	42	37	29	18	-	-
PULSAR DRY 40/50		57	53	48	36	22	-	-
PULSAR DRY 50/50		72	68	60	46,5	31	-	-
PULSAR DRY 65/50		88	83	74	60	38,5	-	-
PULSAR DRY 30/80	H (m)	49	46	43	37	31	22,5	12
PULSAR DRY 40/80		64	60	56	48	41	31	18
PULSAR DRY 50/80		75	71	66	60	50	37	20

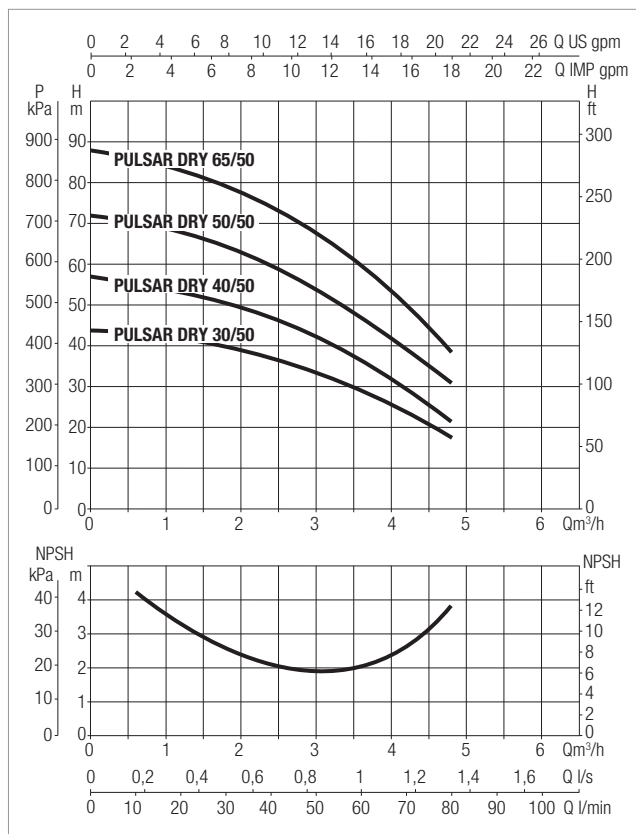

The performance curves are based on kinematic viscosity values = 1 mm²/s and density equivalent to 1000 kg/m³. Curve tolerance according to ISO 9906.

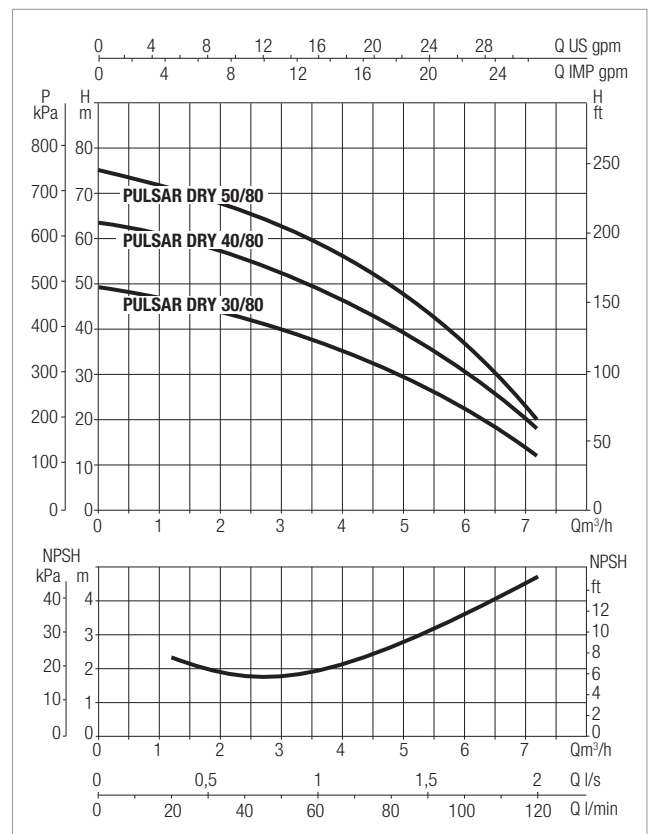

The performance curves are based on kinematic viscosity values = 1 mm²/s and density equivalent to 1000 kg/m³. Curve tolerance according to ISO 9906.

ELECTRICAL DATA AND DIMENSIONS - PULSAR DRY 50

MODEL	ELECTRICAL DATA							H mm	PACKING DIMENSIONS			VOLUME PACKING m ³	Q.TY X PALLET	WEIGHT kg
	POWER INPUT 50 Hz	P1 kW	P2 NOMINAL		I _n A	CAPACITOR			L/A	L/B	H			
			kW	HP		μF	Vc							
PULSAR DRY 30/50 M-NA	1 x 230 V ~	1	0,65	0,87	4,5	20	420	602	745	232	250	0,043	15	16,7
PULSAR DRY 30/50 T-NA	3 x 230 V ~	1	0,64	0,86	3,4	-	-	602	745	232	250	0,043	15	17,3
	3 x 400 V ~	1	0,64	0,86	2	-	-	602	745	232	250	0,043	15	17,3
PULSAR DRY 40/50 M-NA	1 x 230 V ~	1,2	0,77	1	5,4	20	420	602	745	232	250	0,043	15	17,3
PULSAR DRY 40/50 T-NA	3 x 230 V ~	1,2	0,79	1,1	3,9	-	-	602	745	232	250	0,043	15	17
	3 x 400 V ~	1,2	0,79	1,1	2,2	-	-	602	745	232	250	0,043	15	17
PULSAR DRY 50/50 M-NA	1 x 230 V ~	1,6	1,13	1,5	7,35	25	420	670	745	232	250	0,043	15	18
PULSAR DRY 50/50 T-NA	3 x 230 V ~	1,5	1,12	1,5	4,85	-	-	670	745	232	250	0,043	15	18,5
	3 x 400 V ~	1,5	1,12	1,5	2,8	-	-	670	745	232	250	0,043	15	18,5
PULSAR DRY 65/50 M-NA	1 x 230 V ~	1,9	1,3	1,7	8,3	30	420	697	745	232	250	0,043	15	19
PULSAR DRY 65/50 T-NA	3 x 230 V ~	1,8	1,3	1,7	6,1	-	-	697	745	232	250	0,043	15	19,5
	3 x 400 V ~	1,8	1,3	1,7	3,5	-	-	697	745	232	250	0,043	15	19,5

ELECTRICAL DATA AND DIMENSIONS - PULSAR DRY CB 50

MODEL	ELECTRICAL DATA							H mm	PACKING DIMENSIONS			VOLUME PACKING m ³	Q.TY X PALLET	WEIGHT kg
	POWER INPUT 50 Hz	P1 kW	P2 NOMINAL		I _n A	CAPACITOR			L/A	L/B	H			
			kW	HP		μF	Vc							
PULSAR DRY CB 30/50 M-NA	1 x 230 V ~	1	0,65	0,87	4,5	-	-	602	745	232	250	0,043	15	16,7
PULSAR DRY CB 40/50 M-NA	1 x 230 V ~	1,2	0,77	1	5,4	-	-	602	745	232	250	0,043	15	17,3
PULSAR DRY CB 50/50 M-NA	1 x 230 V ~	1,6	1,13	1,5	7,35	-	-	670	745	232	250	0,043	15	18
PULSAR DRY CB 65/50 M-NA	1 x 230 V ~	1,9	1,3	1,7	8,3	-	-	697	745	232	250	0,043	15	19

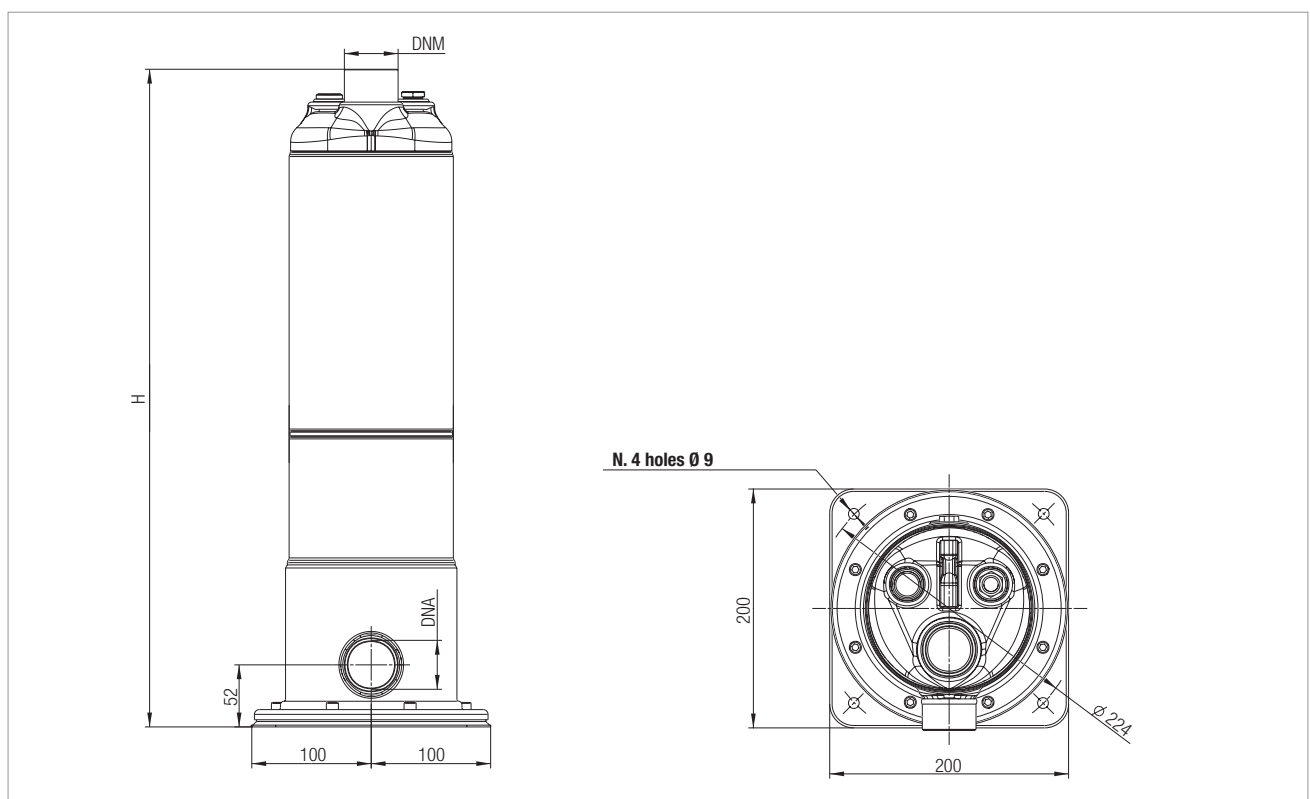

ELECTRICAL DATA AND DIMENSIONS - PULSAR DRY 80

MODEL	ELECTRICAL DATA							H mm	PACKING DIMENSIONS			VOLUME PACKING m ³	Q.TY X PALLET	WEIGHT kg
	POWER INPUT 50 Hz	P1 kW	P2 NOMINAL		I _n A	CAPACITOR			L/A	L/B	H			
			kW	HP		μF	Vc							
PULSAR DRY 30/80 M-NA	1 x 230 V ~	1,2	0,78	1,05	5,5	20	420	602	745	232	250	0,043	15	17
PULSAR DRY 30/80 T-NA	3 x 230 V ~	1,2	0,78	1,1	4	-	-	602	745	232	250	0,043	15	17,5
	3 x 400 V ~	1,2	0,78	1,1	2,3	-	-	602	745	232	250	0,043	15	17,5
PULSAR DRY 40/80 M-NA	1 x 230 V ~	1,6	1,1	1,5	7,4	25	420	670	745	232	250	0,043	15	18
PULSAR DRY 40/80 T-NA	3 x 230 V ~	1,5	1,1	1,5	4,85	-	-	670	745	232	250	0,043	15	18,5
	3 x 400 V ~	1,5	1,1	1,5	2,8	-	-	670	745	232	250	0,043	15	18,5
PULSAR DRY 50/80 M-NA	1 x 230 V ~	1,9	1,3	1,7	8,3	30	420	697	745	232	250	0,043	15	19
PULSAR DRY 50/80 T-NA	3 x 230 V ~	1,8	1,3	1,7	5,9	-	-	697	745	232	250	0,043	15	19,5
	3 x 400 V ~	1,8	1,3	1,7	3,4	-	-	697	745	232	250	0,043	15	18,5

ELECTRICAL DATA AND DIMENSIONS - PULSAR DRY CB 80

MODEL	ELECTRICAL DATA							H mm	PACKING DIMENSIONS			VOLUME PACKING m ³	Q.TY X PALLET	WEIGHT kg
	POWER INPUT 50 Hz	P1 kW	P2 NOMINAL		I _n A	CAPACITOR			L/A	L/B	H			
			kW	HP		μF	Vc							
PULSAR DRY CB 30/80 M-NA	1,2	0,78	1,05	5,5	5,5	-	-	602	745	232	250	0,043	15	17
PULSAR DRY CB 40/80 M-NA	1,6	1,1	1,5	7,4	7,4	-	-	670	745	232	250	0,043	15	18
PULSAR DRY CB 50/80 M-NA	1,9	1,3	1,7	8,3	8,3	-	-	697	745	232	250	0,043	15	19

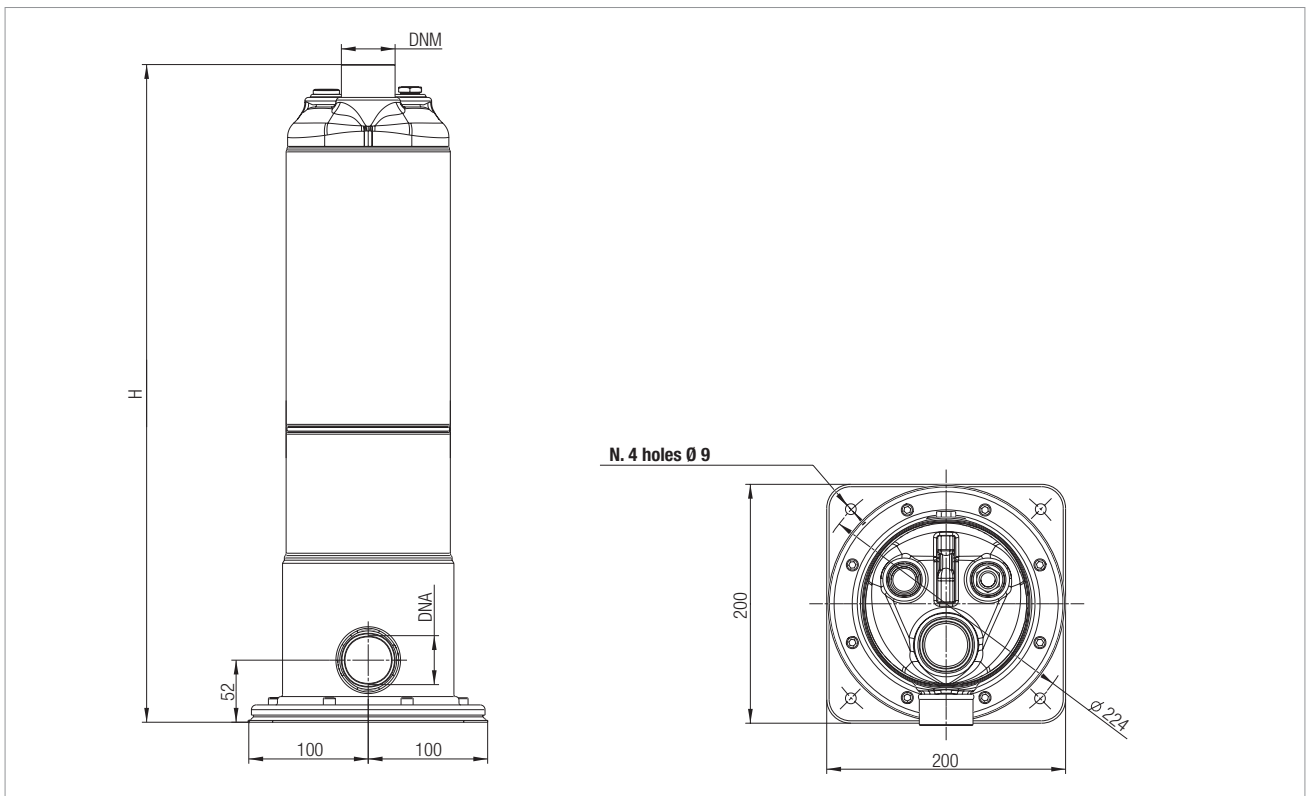

DAB
PUMPS SELECTOR

On-line product selection



DAB PUMPS LTD.
Unit 6 Gilberd Court
Newcomen Way, Severalls Park
CO4 9WN
Colchester
ordersuk@dwgroup.com
Tel. +44 0333 777 5010



DAB PUMPS IBERICA S.L.
Calle Verano 18-20-22
28850 - Torrejón de Ardoz - Madrid
Spain
Info.spain@dwgroup.com
Tel. +34 91 6569545



DAB PUMPS DE MÉXICO, S.A. DE C.V.
Av Amsterdam 101 Local 4
Col. Hipódromo Condesa,
Del. Cuauhtémoc CP 06170
Ciudad de México
Tel. +52 55 553 2621



DAB PUMPS BV
'tHofveld 6 C1
1702 Groot Bijgaarden - Belgium
info.belgium@dwgroup.com
Tel. +32 2 4668353



DAB PUMPS HUNGARY KFT.
H-8800
Nagykanizsa, Buda Ernő u.5
Hungary
Tel. +36 93501700



DAB PUMPS SOUTH AFRICA (PTY) LTD
Twenty One industrial Estate,
16 Purlin Street, Unit B, Warehouse 4
Olifantsfontein -1667 - South Africa
info.sa@dwgroup.com
Tel. +27 12 361 3997



DAB PUMPS B.V.
Statenlaan, 4
5223 LA, 's-Hertogenbosch
Nederland
info.nl@dabpumps.com
Tel. +31 416 387280



DAB PUMPS POLAND Sp. z o.o.
Ul. Cieslewskich 35K
03-017 Warszawa - Poland
sprzedaz@dabpumps.com.pl



DAB PUMPS (QINGDAO) CO. LTD.
No.10 Xindong Road
Jiulong Town,
Jiaozhou City
266319 Qingdao (Shandong) - China
sales.cn@dwgroup.com
Tel. +86 400 186 8280



DAB PUMPS FRANCE SAS
Tour Ariane, Paris la Défense 9
5, Place de la Pyramide
92800 Puteaux - France
info.fr@dabpumps.com
Tel. +33 (0)6 79 63 05 46
+33 (0)7 89 01 53 35



DAB PUMPS INC.
3226 Benchmark Drive
Ladson, SC 29456 - USA
info.usa@dwgroup.com
Tel. 1- 843-797-5002
Fax 1-843-797-3366



DAB PUMPS OCEANIA PTY LTD
426 South Gippsland Highway,
Dandenong South VIC 3175 - Australia
info.oceania@dwgroup.com
Tel. +61 1300 378 677



DAB PUMPS GMBH
Am Nordpark 3
D - 41069 Mönchengladbach - Germany
info.germany@dwgroup.com
Tel. +49 2161 47388-0
Fax +49 2161 47388-36



DAB PUMPS CANADA INC.
333 Bay Street, Suite 4600, Toronto,
Ontario, M5H 2S5, - Canada
orders@dwgroup.ca
Tel. 1-833-322-7867



PT DAB PUMPS INDONESIA
Satrio Tower lantai 26
unit C-D, Jl. Prof. Dr. Satrio Kav. C4,
Kel. Kuningan Timur, Kec. Setiabudi, Kota Adm.
Jakarta Selatan, Prov. DKI Jakarta. - Indonesia
Tel. +62 2129222850